

DROOPLE PRODUCT CATALOGUE & PRICE LIST 2025

Recommended Retail Prices (Ex Works)



droople

ROUTE DU VERNEY 18, 1070 PUIDOUX, SWITZERLAND

+41 21 357 14 91 | contact@droople.com | www.droople.com

TURN YOUR ASSETS SMART WITH DROOPLE WATER INTELLIGENCE PLATFORM

Droople Analytics

Parameters

- Flow
- Conductivity
- Pressure
- Temperature

A wide range of Water Assets

- Water Dispenser
- Toilet
- Urinal
- Sink
- Shower
- Main meter
- Sub meter
- Carbon filter
- Sediment filter
- Reverse Osmosis
- Softener
- CO² canister
- Ceramic filter
- Appliances
- Chemical Tank
- Other assets



Beverage dispensers

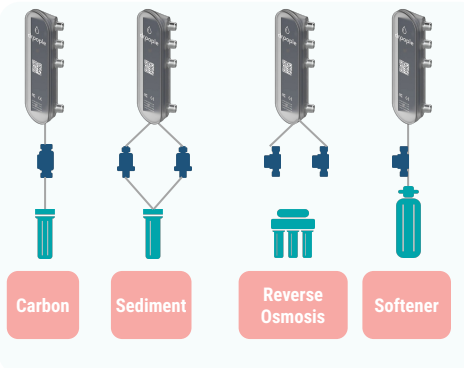
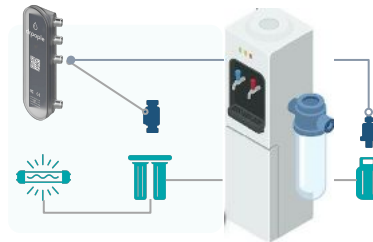

Water treatment systems with up to 3 sensors with infinite combinations



Sanitary ware or any asset without access to power



DROOPLE iLINK© NB-IoT PROVIDES A WIDE RANGE OF COMBINATIONS TO MANAGE YOUR WATER ASSETS

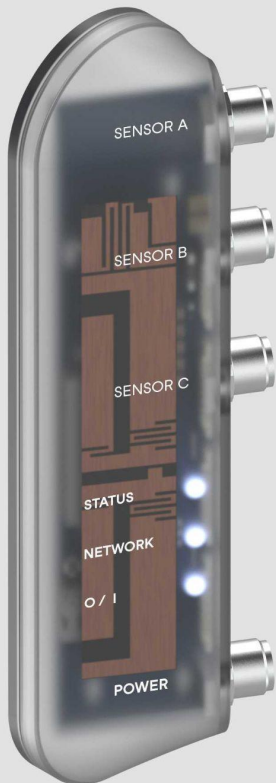

[Follow the installation instructions here](#)

1. Sensor agnostic with analog or digital sensors

Mediums: Water | Gas | other fluids upon request
Measures: Flow | Pressure | Conductivity | Temperature | *pH | Chlorine coming in 2025



Flow
1/2" - 2"
T° is indicative



Pressure for
water or gas
10 | 100 bar



Flow & T°
& Conductivity
in 1 sensor

2. 5' Plug & Play installation & configuration

The plumbing installation remains the same, however the sensors come with M12 connectors for dumb proof wiring. Power the device and it will download its configuration.

3. Over-the-Air (OTA) updates

Seamlessly deploy bug fixes and new features ensuring your device stays up-to-date without any manual intervention.

4. Edge Intelligence

New duty cycle with time stamped cycles, cycle duration, water consumption per cycle, flow rate are all the analytics computed on the edge without any loss of granularity.

5. NB-IoT vs LoRa

NB-IoT enables larger payloads, 2-minute sampling, and higher data granularity for optimal asset monitoring. It supports up to 3 channels, each connecting a sensor, offering broader coverage per device compared to the LoRa version.



DROOPLE FOR BEVERAGE AND WATER TREATMENT SYSTEMS

(click [here](#) to access to our fountainOS website)



Software Licence for fountainOS® with HW Purchase only	METRIC	CHF	EUR	USD	GBP
Droople fountainOS 1-Year 5' sample rate API excluded	per Device	88	95	95	80
Droople fountainOS 1-Year 5' sample rate TDS API excluded	per Device	120	130	130	110
Droople fountainOS 1-Year Automated Gas Bottle Logistic	per Device	30	33	33	28
Droople Basic API 1-Year 2000 requests per day	per Token	60	65	65	55
Droople Advanced API 1-Year 20'000 requests per day	per Token	565	610	610	515

HW Purchase + SaaS Conditions: The annual software license covers unlimited users but excludes API access. The subscription is billed pro-rata yearly upfront based on the sales order date. Renewals are automatically charged on January 1st, with a pro-rata credit for unused days before device activation. Cancellations require a 3-month notice by September 30th each year. A 9-month grace period applies for devices not yet connected to the platform.

Droople iLink® NB-IoT HW Purchase	THREAD SIZE	MEASUREMENTS	CHF	EUR	USD	GBP
Droople NB-IoT Module (RoW, EU, US)	N/A	N/A	250	275	275	230
Droople Flow Sensor	1/2", 3/4", 1"	Flow	45	50	50	40
Droople Pressure Sensor (Water or CO2)	1/4"	Pressure	65	70	70	60
Droople TDS Sensor	1/4", 3/8", 1/2", 3/4"	Flow, T°, µS/cm	145	160	160	130
Promo Kit Droople Smart Flow Mono	1/2", 3/4", 1"	Flow	250	275	275	230
Promo Kit Droople Smart TDS Mono	1/4", 3/8", 1/2", 3/4"	Flow, T°, µS/cm	320	355	355	290
Promo Kit Droople Smart Flow + Pressure CO2	1/4", 3/8", 1/2", 3/4"	Flow, CO2 Pressure	350	385	385	320
Promo Kit Droople Smart TDS + Pressure CO2	1/4", 3/8", 1/2", 3/4"	Flow, T°, µS/cm, CO2	390	430	430	355
Promo Kit Droople Smart TDS Twin (2 Streams)	1/4", 3/8", 1/2", 3/4"	Flow, T°, µS/cm	450	495	495	410
Pressure regulator 7 bar CO2 BSP 1/2"	1/2"	N/A	60	70	70	55

NB: Conductivity is expressed in µS/cm and is compensated by the temperature measurement (TDS).

Droople iLink® NB-IoT HW-as-a-Service (HaaS) License	METRIC	CHF	EUR	USD	GBP
App FountainOS 1-Year Includes NB-IoT Flow or Flow & CO2	per Device	170	190	190	155
App FountainOS 1-Year Includes NB-IoT TDS & CO2	per Device	220	245	245	200
Promo Kit App FountainOS 1-Year	MOQ = 100 assets	contact your sales representative			

HaaS License Conditions: The contract requires a minimum 3-year commitment, with automatic yearly renewals charged upfront. The subscription begins upon device receipt, regardless of activation, and continues in 1-year renewal cycles. Unused credits are non-refundable. Cancellations require a 3-month notice by September 30th, applicable after the initial 3-year term.

- > Droople assumes no responsibility for any errors contained herein. All product information is subject to change without notice.
- > Please contact your Droople representative for the latest version of this document.

DROOPLE iLINK© LoRa PROVIDES A WIDE RANGE OF COMBINATIONS TO MANAGE YOUR WATER ASSETS

1. Sensor agnostic with analog or digital sensors

Mediums: Water | Gas | other fluids upon request
Measures: Flow | Pressure | Conductivity | Temperature | *pH | Chlorine coming in 2025



Flow
1/2" - 2"
T° is indicative



Pressure for
water or gas
10 | 100 bar



Flow & T°
& Conductivity
in 1 sensor

2. Plug & Play installation

1 battery of 2'600 mAh for up to 5 years*
for seamless installation and optimized TCO

3. Edge Intelligence

of cycles, cycle time, water usage per cycle, flow rate are all the analytics computed on the module

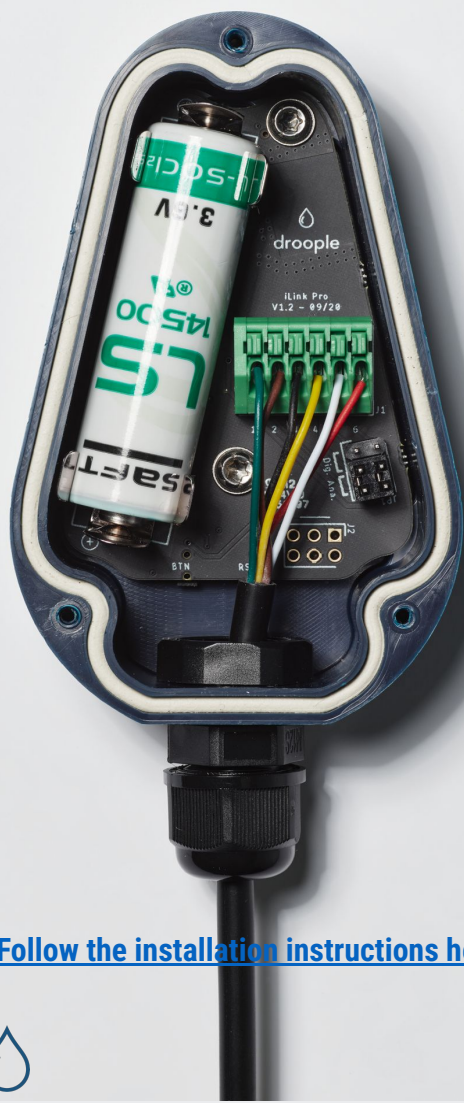

[Follow the installation instructions here](#)



LoRaWAN battery lifetime with ideal communication conditions and optimal RSSI indicator above -50 dB operated edge device capable of versatility based on analog/digital reading of sensors. Energy management with ultra-low power grade. Multi-frequency band modulation (US; EU, AS) and edge processing (converting raw sensor data to pre-processed consumption, cycle, delta, variance, etc.). Can connect up-to 4 sensors (2 pressure IN & OUT + 2 TRIO sensor for conductivity delta)



DROOPLE FOR MANY ASSETS PER LOCATION

(click [here](#) to access to our main website)



Software Licence for Droople App with HW Purchase only	METRIC	CHF	EUR	USD	GBP
Droople Basic App 1-Year 5' sample rate API excluded	per Device	88	95	95	80
Droople Advanced App 1-Year 1' sample rate API excluded	per Device	120	130	130	110
Droople fountainOS 1-Year 5' sample rate TDS API excluded	per Device	120	130	130	110
Droople Basic API 1-Year 2000 requests per day	per Token	60	65	65	55
Droople Advanced API 1-Year 20'000 requests per day	per Token	565	610	610	515
Droople Advanced App 1-Year evercleanOS® & QR Code	per Space*	700	735	790	635
Droople Advanced App 1-Year schoolOS®	per Space*	700	735	790	635

HW Purchase + SaaS Conditions: The annual software license covers unlimited users but excludes API access. The subscription is billed pro-rata yearly upfront based on the sales order date. Renewals are automatically charged on January 1st, with a pro-rata credit for unused days before device activation. Cancellations require a 3-month notice by September 30th each year. A 9-month grace period applies for devices not yet connected to the platform.

Connectivity	REGIONS	DATA PLAN	CHF	EUR	USD	GBP
MINI HUB LoRa to Wi-Fi MAX 20 droople 	AS EU US	INCLUDED	100	110	110	90
PICONEXT LoRa to 4G MAX 50 droople 	AS EU US	INCLUDED	200	220	220	180

Droople iLink® LoRAWAN	THREAD SIZE	MEASUREMENTS	CHF	EUR	USD	GBP
Droople iLink LoRAWAN Module (AS, EU, US)	N/A	N/A	100	110	110	90
Droople Flow Sensor*	½", ¾", 1"	Flow	45	50	50	40
Droople Pressure Sensor (Water or CO2)	¼"	Pressure	65	70	70	60
Droople TDS Sensor*	¼", ⅜", ½", ¾"	Flow, T°, µS/cm	145	160	160	130
Promo Kit Droople Flow Mono	½", ¾", 1"	Flow	125	140	140	110
Promo Kit Droople Flow Twin (2 Streams)	½", ¾", 1"	Flow - Hot & Cold	150	165	165	135
Promo Kit Droople Smart Flow + Pressure CO2	¼", ⅜", ½", ¾"	Flow, CO2 Pressure	250	275	275	220
Promo Kit Droople TDS Mono	¼", ⅜", ½", ¾"	Flow, T°, µS/cm	250	275	275	220
Promo Kit Droople TDS Twin (2 Streams)	¼", ⅜", ½", ¾"	Flow, T°, µS/cm	400	440	440	365
Promo Kit Droople Outdoor Flow Mono	1", 1½", 2"	Flow	650	685	725	585
Pressure regulator 7 bar CO2 BSP 1/2"	½"	N/A	60	70	70	55

NB: Conductivity is expressed in µS/cm and is compensated by the temperature measurement (TDS).

*Other thread dimensions upon request. Droople Device Mono:  Droople Device Twin (2 same sensors): 

> Droople assumes no responsibility for any errors contained herein. All product information is subject to change without notice.
 > Please contact your Droople representative for the latest version of this document.

DROOPLE PREMIUM & SHIPPING SERVICES

(click [here](#) to access to our main website - Ex Works)



PREMIUM SERVICES	ATTENDEES	DELIVERABLES	CHF	EUR	USD	GBP
Droople Training - Onboarding*	2	4-hour workshop on the Droople Cloud Platform	700	735	790	635
Additional Attendee for Training	Per attendee	Additional participants for the training session	200	210	225	180
Droople Express Training - Onboarding*	2	1-hour workshop on the Droople Cloud Platform	300	310	335	265
Droople Premium Service - Remote*	1	4 hours of access to DROOPLE's Technical Support	800	840	900	725
Droople Worksite Package - Remote*	Per meter	Set-up, space denomination, assets & entities configuration, alarms & users management, archiving	250	260	280	220
Droople Premium Service - On Site	N/A	DROOPLE's Technical Support On-Site at Customer Location	upon quotation			

*The service must be booked 4 weeks in advance and is performed remotely.

SHIPPING & ORDER HANDLING	DELAY	INCLUDED ITEM	CHF	EUR	USD	GBP
Standard order	6/8 weeks	Standard Shipping EU Worldwide	The charges depend on weight, dimensions, & destination of parcel			
Express Order handling for a maximum of 50 units (shipping cost excluded)	5 days	Express handling or specific assembly	600	630	675	545

> Droople assumes no responsibility for any errors contained herein. All product information is subject to change without notice.
 > Please contact your Droople representative for the latest version of this document.